

This manual explains how to use additional option licenses to add option to a AQ7290 series OTDR (Optical Time Domain Reflectometer). To ensure correct use, please read this manual thoroughly before beginning operation.

### Contents of the Package

The following items are included in the package. If the wrong items have been delivered or if items are missing, contact your nearest YOKOGAWA dealer.

Item	Description	Quantity
Product Information	Contains the model and suffix code of the option license, the license key, and the instrument number of the AQ7290 series that the option is to be added to. To add the option to the relevant product, the license key written on this sheet is necessary. Keep this sheet in a safe place.	1 sheet
Suffix Code Label	A label that proves that the option has been added to the relevant product. After adding the option, be sure to affix this label on the relevant product.	1 sheet
Protection Sheet	The clear sheet to protect a suffix cord label.	1 sheet
User's Manual	This manual.	1 copy

Models	Function	Note
735052-MNT-000	Monitoring function	—
735052-FST-000	Fiber surface test function	—

### Installing an Option

#### Checking the Product That the Option Will Be Added To

1. Check that the instrument number of the AQ7290 series that you want to add the option to matches the instrument number written on the Product Information sheet.  
If you try to add an option to a AQ7290 series with a different instrument number, an error will appear in step 8.

#### Starting the AQ7290 series

2. Turn on the AQ7290 series power switch to start the AQ7290 series.  
For details on how to turn on the power switch, see in the Getting Started Guide (IM AQ7290-02EN).

#### System Setup/Adding an Option

3. Press **MENU** to display the MENU screen.
4. Press **SETUP** to display the System Setup screen.
5. Tap the **Option Installation** button to display the Option Installation screen.

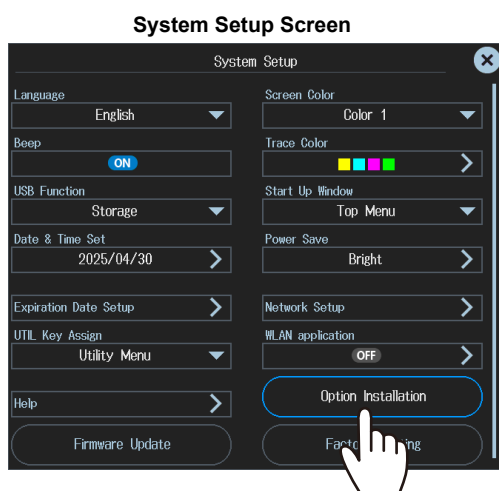

Option Installation Screen

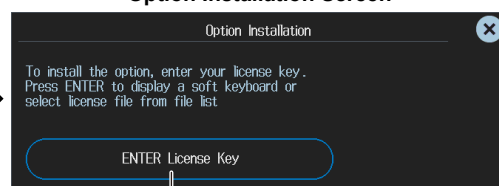

6. Tap the **ENTER License Key** button to display the character input dialog box.

Character input dialog box

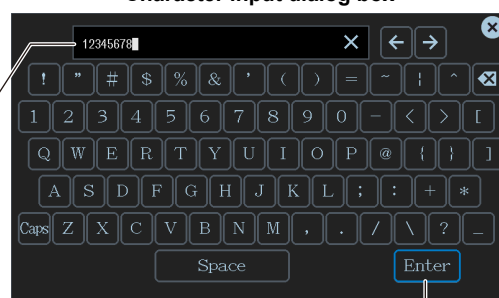

Enter button

7. Using the character input dialog box, enter the license key correctly.
8. Tap the **Enter** button on the character input dialog box. The additional option will be installed.

## Note

If an error appears, check the following items.

- If the instrument number of the AQ7290 series that you are trying to add the option to does not match the instrument number written on the Product Information sheet, you cannot install the option.
- If the instrument numbers are matched, press **ESC** to clear the error, install the option again from step 6, and enter the license key correctly.
- If the instrument numbers are matched and you enter the license key correctly but an error still appears, contact your nearest YOKOGAWA dealer.

## CAUTION

Do not turn off the AQ7290 series until the following screen appears after you press Enter. If the AQ7290 series is turned off during this period, the AQ7290 series may no longer start, or option and other information may be lost.

## ATTENTION

Ne pas mettre hors tension les série AQ7290 avant l'apparition de l'écran suivant après avoir appuyé sur Entrée. Si les série AQ7290 sont mis hors tension pendant cette période, les série AQ7290 risquent de ne plus démarrer, ou l'option et d'autres informations risquent d'être perdues.

When the option is installed successfully, the following screen appears.

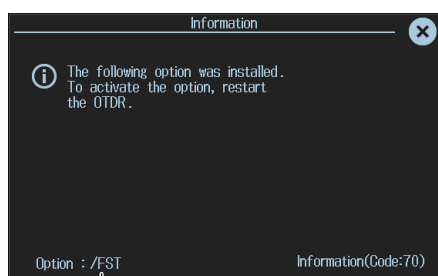

### Additional option indication

The installed additional option is displayed.

### Restarting the AQ7290 series

Restart the AQ7290 series. The additional option will be activated.

## Viewing the Production Information

1. Press **MENU** to display the MENU screen.
2. Tap the icon  to display the Production Information screen.

### MENU screen



### Product Information screen



**Saves the product information screen as an image.**  
The image is saved to a BMP file.

## Note

The SUFFIX (suffix code) inscribed in the AQ7290 series name plate indicates the installed options at the time of factory shipment. After adding options, check the options on the AQ7290 series production information screen.

---

## Affixing the Suffix Code Label

Be sure to affix the suffix code label (included with the Product Information sheet) to the AQ7290 series that you have added an option to. Before affixing the label, wipe the surface clean with a clean dry cloth. Affix the protection sheet over the suffix code label.

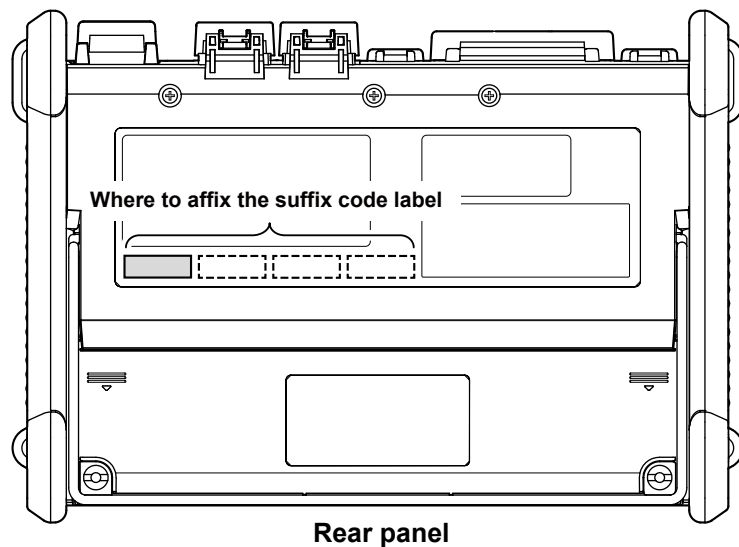

### Note

If the suffix code label is not affixed and we need to update the firmware of the relevant product during repairs or other services at our factory, we may not be able to return your product with the added option installed.

---